

# FLOW SYSTEM MATIC WATER FLOW REGULATOR

## INSTALLATION INSTRUCTIONS FOR FSM WATER FLOW METER



### NEVER BEFORE SO SIMPLE

- Easily and Quickly Mounted
- Easily and Quickly Piped
- Easily and Quickly Cleaned
- Easily and Quickly Change Flow Rate

RETURN TO TOWER

Outlet

3/4 FEMALE

Inlet FROM TOWER

RETURN FROM MOLD TO MOLD



**FSM-600-080**

12mm Hose Barb

- \* Improved quality of parts through precise water control,
- \* Can be used with Ethylene & Propylene Glycol,
- \* Quick and easy reproduce able settings when changing molds,
- \* Heavy duty construction, long life,
- \* Easy mounting on any make or model of machine,
- \* Saves energy from faster startups,
- \* Temp. gauge for each tube,
- \* Flow tubes : Special polyamide nylon material (not polycarbonate) adjustable reference ring and contains brass float cone. Reference marks are molded-in, not printed on. Removes easily for cleaning

P/N. NO

59501

59502

59503

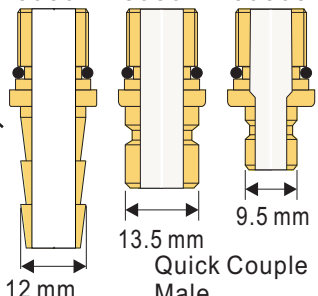

12 mm

13.5 mm

9.5 mm

Quick Couple Male

快速接頭公栓

STANDARD PART 59501

OPTION PARTS

P/N. QUICK COUPLE 59502

P/N. QUICK COUPLE 59503

Hose barb

軟管接頭

可使用3/8" 或者是1/2"



金榜塑膠有限公司

**ONDA PLASTIC CO., LTD.**

4F, NO.80 Kuan Fu Rd sec 2,  
Sanchung 241, Taipei, Taiwan

Tel: 886 2 8512 3761 Fax: 886 2 8512 3765

www.ondaplas.com e-mail: onda@ms17.hinet.net

e-mail : sales@ondaplas.com

# FLOW SYSTEM MATIC WATER FLOW REGULATOR

## INSTALLATION INSTRUCTIONS FOR FSM WATER FLOW METER

### Overall Size

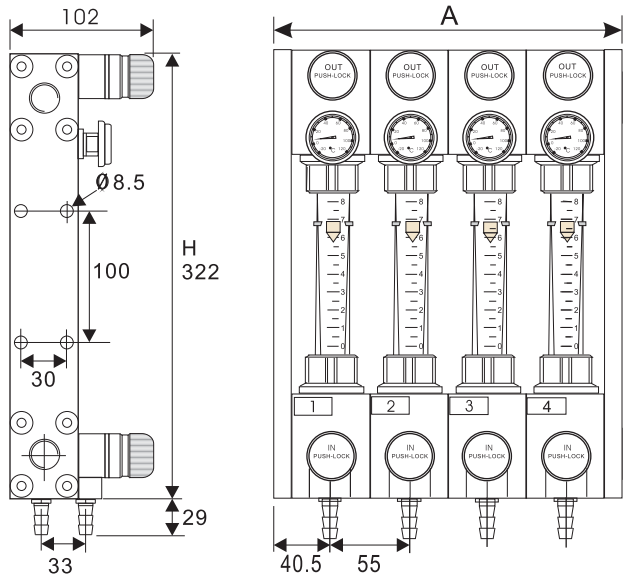

Model	Overall Size		
	A Width (mm)	Depth (mm)	Height (mm)
FSM-200	130	105	351
FSM-300	185	105	351
FSM-400	245	105	351
FSM-500	302	105	351
FSM-600	358	105	351
FSM-800	468	105	351
FSM-900	525	105	351
FSM-1000	580	105	351
FSM-1200	690	105	351

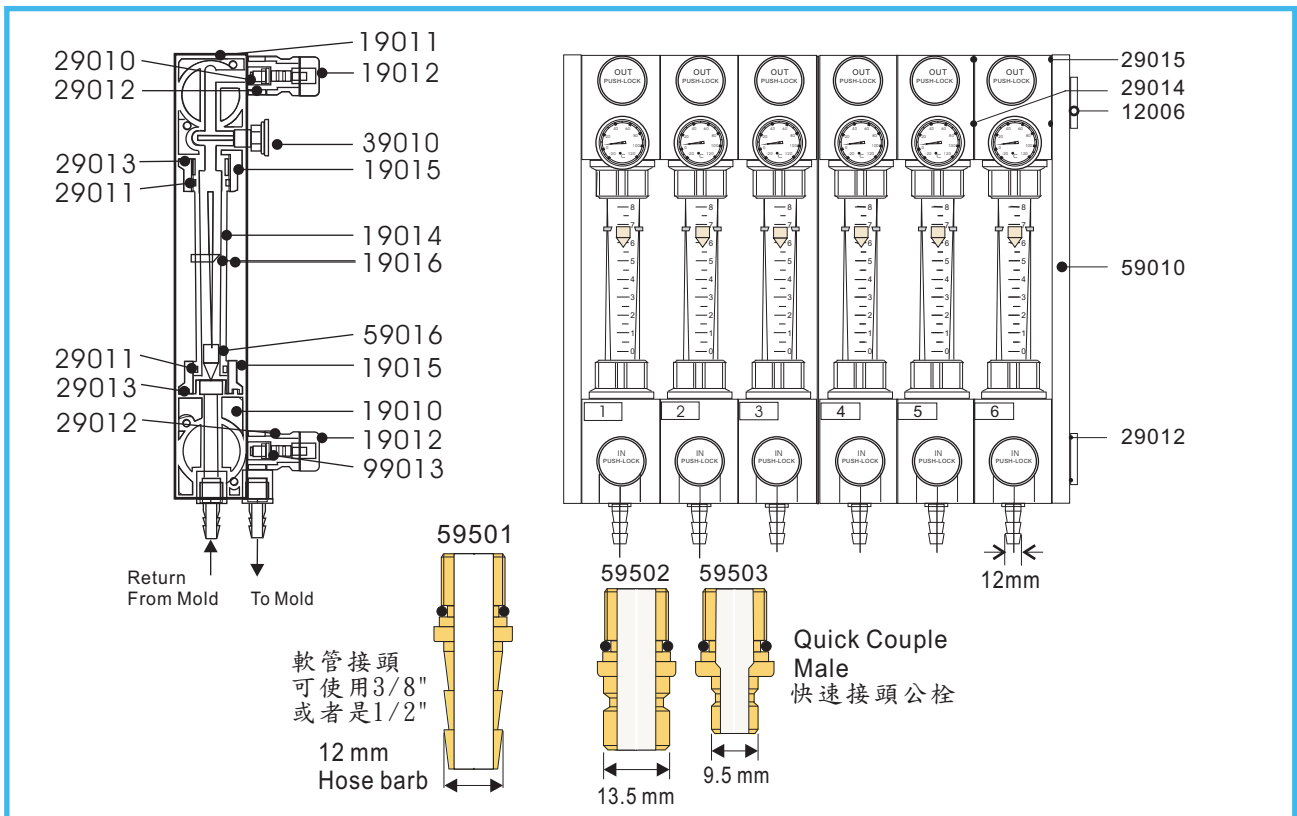

### Part Number.

Part No.	Description	Part No.	Description	Part No.	Description
19010	Lower Body	29010	O-Ring	59065	Float Cone
19011	Upper Body	29011	O-Ring	59080	Float Cone
19012	Hand Wheel	29012	O-Ring	59110	Float Cone
99013	Control Valve	29013	O-Ring	59130	Float Cone
19014	Flow Tube	29014	O-Ring	59024-2 To	Screw
19015	Flow Tube Nut	29015	O-Ring	59024-12	Screw
19016	Flow Indicator	39010	Thermometer	59050	Mid Plate
12006	Plug	59010	R.L.Side Plate	59061	Brush
59501	12 mm hose barb	59502	13.5mm Q.Couple	59503	9.5mm Q.Couple

# FLOW SYSTEM MATIC WATER FLOW REGULATOR

## INSTALLATION INSTRUCTIONS FOR FSM WATER FLOW METER

### Piping

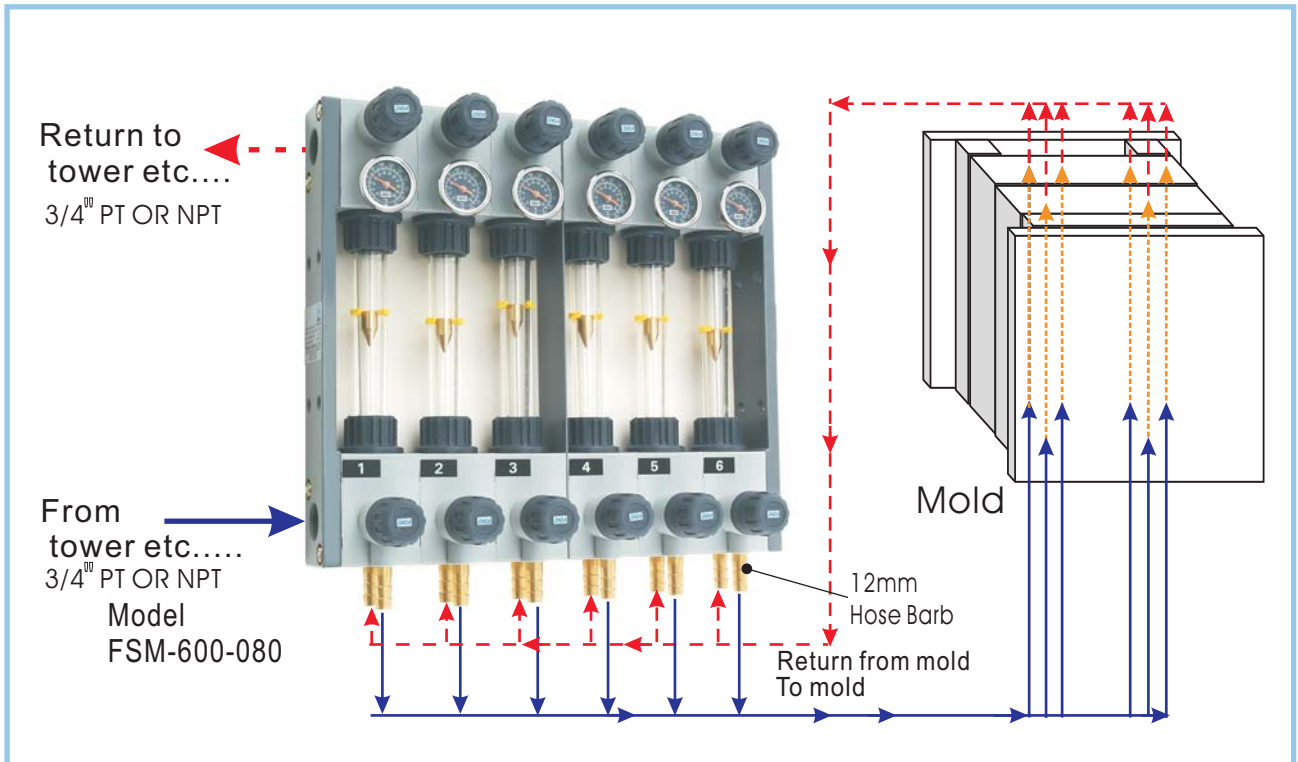

### Standard Model \*

FSM-200-065	* FSM-200-080	FSM-200-110	FSM-200-130
FSM-300-065	* FSM-300-080	FSM-300-110	FSM-300-130
FSM-400-065	* FSM-400-080	FSM-400-110	FSM-400-130
FSM-500-065	* FSM-500-080	FSM-500-110	FSM-500-130
FSM-600-065	* FSM-600-080	FSM-600-110	FSM-600-065
FSM-800-065	* FSM-800-080	FSM-800-110	FSM-800-130
FSM-900-065	* FSM-900-080	FSM-900-110	FSM-900-130
FSM-1000-065	* FSM-1000-080	FSM-1000-110	FSM-1000-130
FSM-1200-065	* FSM-1200-080	FSM-1200-110	FSM-1200-130

### PRESSURE VS TEMPERATURE

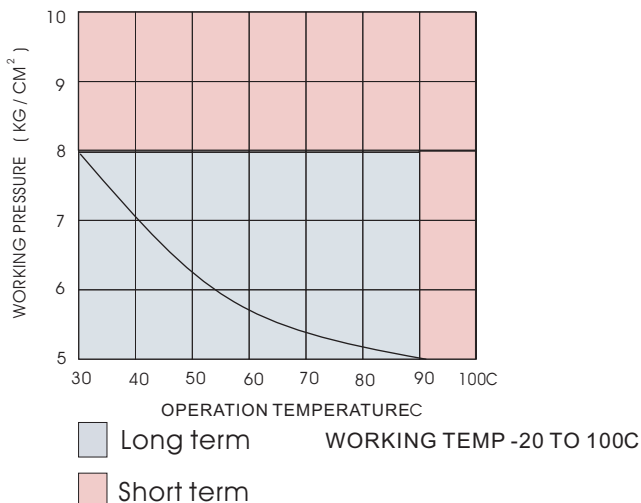

### FSM-400-080

- Flow per each zone 8 L/Min
- 4 zone per unit
- 12mm Hose barb
- Flow System Matic

### FSM-800-110

- Flow per each zone 11 L/Min
- 8 zone per unit
- 12mm Hose barb
- Flow System Matic

# FLOW SYSTEM MATIC WATER FLOW REGULATOR

## INSTALLATION INSTRUCTIONS FOR FSM WATER FLOW METER

### BENEFITS OF THE MODEL FSM WATER FLOW METER WATER FLOW REGULATOR

- A. ONE SIZE DOES ALL 6.5, 8.0, 11.0, 13.0 L/MIN
- B. GLASS FILLED NYLON CONSTRUCTION, NO RUSTING OR CHEMICAL CORROSION
- C. EASILY CLEANING WITH REMOVE FLOW TUBE NUT & BRUSH CLEAN OUTSIDE
- D. NUMBERS OF ZONE CAN BE INCREASED OR REDUCED EASILY, REQUIRING NO SPECIAL TOOLS
- E. FLOW ZONE CONTROL KNOBS CAN BE LOCKED
- F. THERMOMETER IS STANDARD ON EACH ZONE
- G. FLOW INDICATOR IS STANDARD ON EACH ZONE
- H. TUBES ARE MADE FROM NYLON 12

### Easy Cleaning

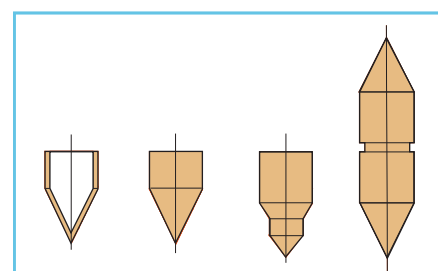
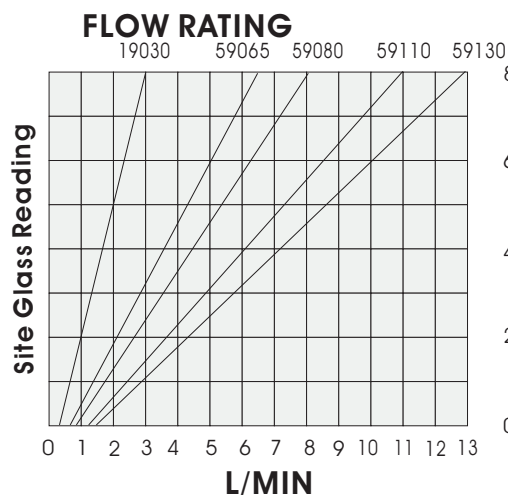
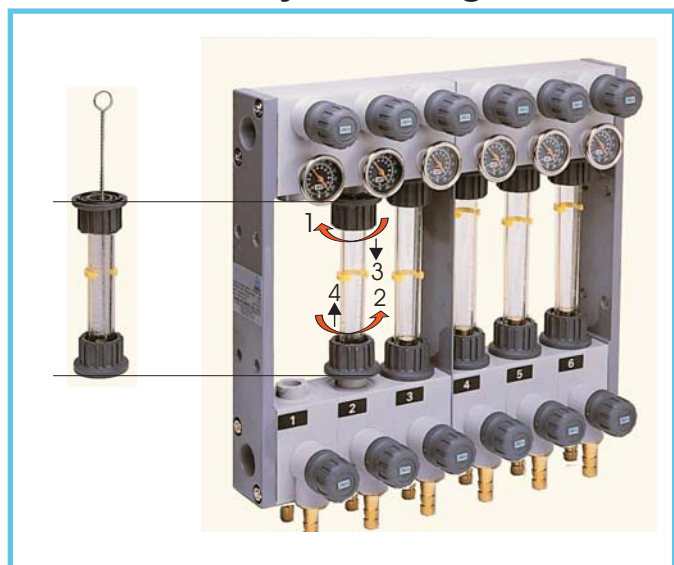
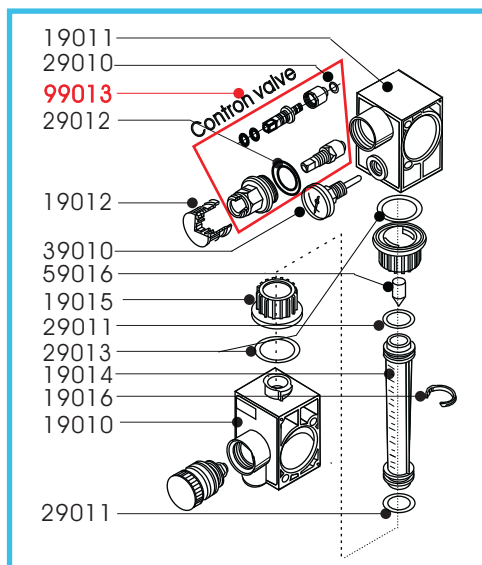

3 L/min Plastic  
6.5 L/min  
8 L/min  
11 L/min  
13 L/min Brass cone

**Float Cone Part No.**  
19030 59065 59080 59110 59130

**NOTE :**  
**ALL MODELS CAN USED SAFELY WITH ETHYLENE & PROPYLENE GLYCOL**



金榜塑膠有限公司  
**ONDA PLASTIC CO., LTD.**

4F, NO.80 Kuan Fu Rd sec 2,  
Sanchung 241, Taipei, Taiwan  
Tel: 886 2 8512 3761 Fax: 886 2 8512 3765  
www.ondaplas.com e-mail: onda@ms17.hinet.net  
e-mail : sales@ondaplas.com